

Exhibition Station New Platform Construction

Phase One: As early as Monday, November 25, 2024, to the end of 2024.

More information for Phase Two to follow in 2025 as work plans progress. The community will be kept informed through additional notices.

Daytime working hours during train operations: Tuesdays to Sundays from 5:30 a.m. to 10:00 p.m.

Overnight working hours during reduced and non-operational train service: Tuesday to Sundays between 10:00 p.m. to 5:30 a.m. Work may occur on Mondays if required.

***GO Train Service changes will be in effect November 29 - December 22, 2024**

Map of work area:

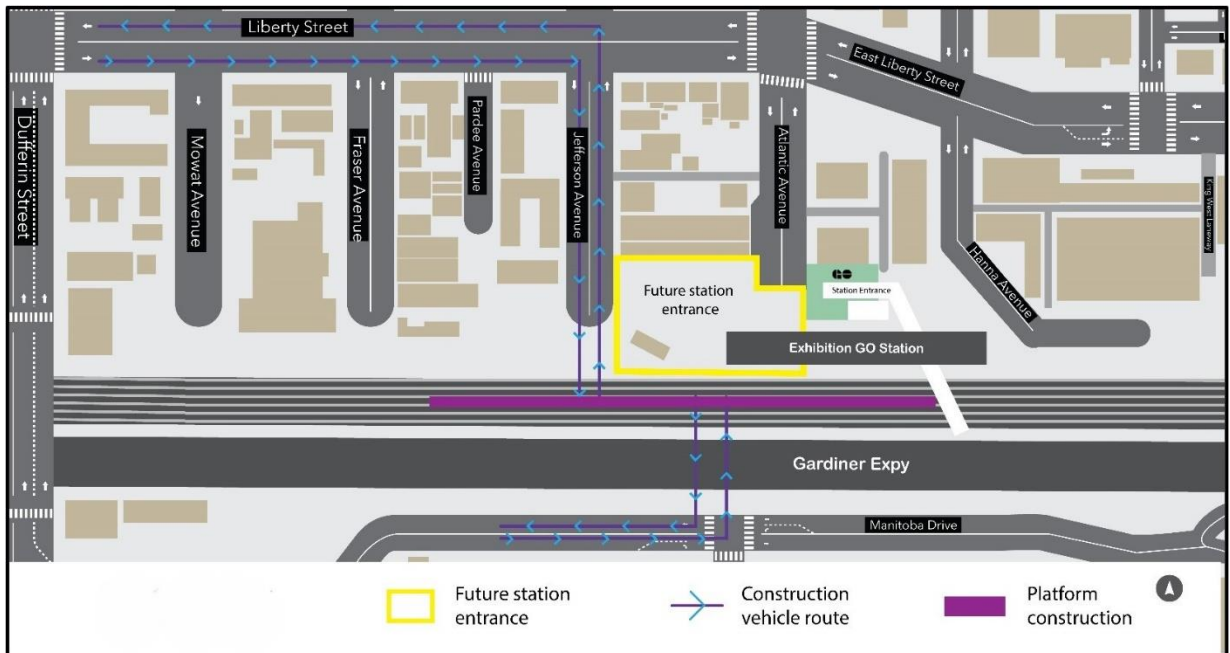

What is happening?

To accommodate the future Ontario Line subway crews are working to build a new and expanded Exhibition Station, by constructing new station platforms and structural supports.

This work will take place entirely within the rail corridor, between the existing tracks through Exhibition GO. Work will occur for day-long cycles, Tuesdays to Sundays, inside the rail corridor.

Dates and hours of work	Construction Activity	Work Details
<ul style="list-style-type: none"> Daytime hours: 5:30 a.m. to 10:00 p.m. 	<p>Crews will be piling new station foundations, which will support construction of a new island platform between the tracks. The platform will increase GO capacity and serve the new Ontario Line at Exhibition Station.</p>	<ul style="list-style-type: none"> Drill rigs will be used during the day to complete piling work.
<ul style="list-style-type: none"> Overnight hours: 10:00 p.m. to 5:30 a.m. 	<p>Crews will place rebar and pour concrete during the overnight period. Additional piling may occur during the overnight hours.</p>	<ul style="list-style-type: none"> Excavators will load materials (spoils) into dump trucks to be hauled off site for disposal. Rebar placement is needed for the durability, safety and longevity of the Exhibition Station platforms. Concrete trucks will pour concrete reinforcing the piles.

What to expect

- **Trains will not service Exhibition GO from 10:00 p.m. November 29 to Sunday December 1. The north (westbound) platform may be required to close earlier than 10:00 p.m. Customer announcements will be provided.**
- **Trains will operate on a modified hourly schedule during weekends from December 6 to December 21, 2024.**
- **For updated train schedules please see [gotransit.com](https://www.metrolinx.com/gotransit). Information will be distributed and communicated at stations across the GO rail network.**
- Construction equipment, including piling rigs, mobile cranes, concrete and hydrovac trucks, are needed for this work. When required, flag personnel will guide vehicles to and from sites, ensuring pedestrian, cyclist, and vehicle safety.
- Residents and businesses can expect to hear noise from piling rigs working in the active rail corridor. Mitigations will be in place to ensure dust and dirt are not spread to city streets, and trucks and other equipment will be kept clean.
- Work may be postponed or re-scheduled due to unforeseen circumstances.
- All necessary construction permits have been obtained.
- For more information about upcoming station work, please visit [metrolinx.com/ontarioline](https://www.metrolinx.com/ontarioline) or sign up for our e-newsletter.

Traffic & pedestrian details

- During this phase of construction, vehicles will access the rail corridor work zone from the north side, via Jefferson Ave and will exit back onto Jefferson Ave.
- A secondary entry point will also be used from the south side, off Manitoba Drive, leading through an access under the Gardiner Expressway, exiting through the same routes, indicated on the map above.
- Pedestrian and customer access will be maintained through Exhibition Station to Liberty Village through and Exhibition Place, using the pedestrian bridge or accessible tunnel, during these closures.

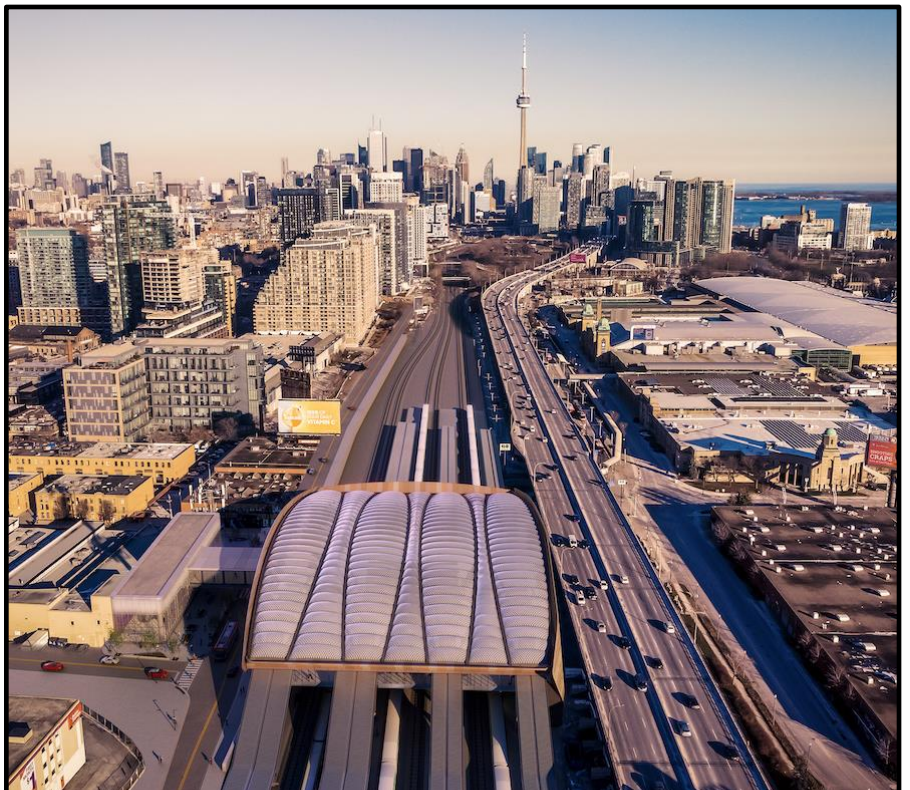

Future-state Exhibition Station, including new island platforms, canopy and integrated Ontario Line.

About the Ontario Line

- 15.6-kilometre subway line that will make it faster and easier to travel within Toronto and beyond.
- 15 stops and more than 40 connections to other transit, including GO train, subway, LRT, streetcar, and bus lines.
- Less than 30 minutes from one end of the line to the other.
- 28,000 fewer cars on the road each day.

Contact us:

Call us 24/7 at: **416-202-5100**

Write to us at: ontarioline@metrolinx.com

Find us on X, Facebook, and Instagram:

[@ontarioline](https://www.ontarioline.com)

Visit the website:

www.metrolinx.com/ontarioline

Visit our community offices:

770 Queen Street East (near Queen & Broadview)

General hours:

Mondays, Tuesdays, and Fridays: 9:00 a.m. to 5:00 p.m.

Wednesday: 1:00 p.m. to 6:00 p.m.

Thursday: 10:00 a.m. to 6:00 p.m.

Thorncliffe Park:

East York Town Centre

45 Overlea Blvd., Toronto, ON M4H 1C3
Unit 153 (across from the Rogers store)

General hours:

Monday - Friday, 9 a.m. - 5 p.m.